

Wedge™ Direct-Inject™ Unit Parts Chart

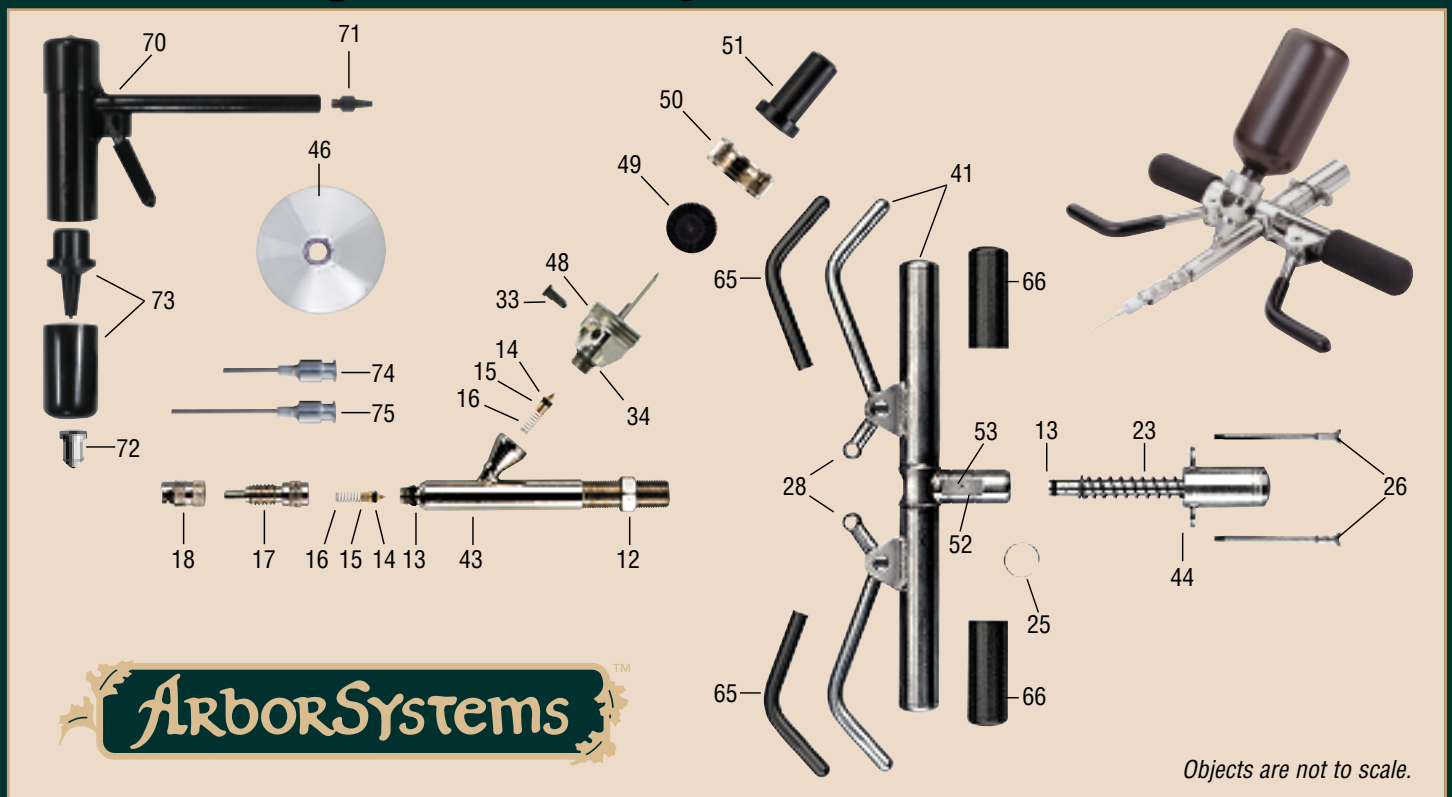

Objects are not to scale.

DRAWING #	PART #	DESCRIPTION
12	PASW12	Lock Nut
13*		Piston O-Ring
14*		Check Valve O-Ring
15*		Check Valve
16*		Check Valve Spring
17	PASW17	Wedge™ Tip Adapter
18	PASW18	Adapter Lock Nut
23	PASW23	Piston Spring
25	PASW25	Dose Adjustment Ring
26	PASW26	Piston Connector Rod
28	PASW28	Lever Nut
33	PASW33	Bottle Drawdown Air Valve
34		Bottle Drawdown Attachment O-Ring
41†		Handle and Lever Assembly (not shown – PASW09 Screw Lever Pivot for units manufactured prior to 2003)
43	PASW43	Main Body
44	PASW44	Piston and Cap Piece
46	PASW46	Deflector Shield
48	PASW48	Bottle Drawdown Attachment
49	PASW49	Bottle Seal
50	PASW50	Bottle Clamp

DRAWING #	PART #	DESCRIPTION
51	PASW51	Storage Cap
52		1/2 ml Dose Adjustment Groove
53		Direct-Inject Model Reference Letter
65	PASW65	Front Hand Grips - Small
66	PASW66	Rear Hand Grips - Large
70	PAWP70	WedgeChek™ Punch
71	PAWP71	WedgeChek™ Punch Tip
72		WedgeChek™
73	PAWP73	WedgeChek™ Adapter & Rubber Sleeve
74		Short .75" Wedge Tip
75		Long 1.5" Wedge Tip
	PASWK001	Seal and Check Valve Parts Kit - Includes: (1) Piston O-Ring (2) Check Valve O-Rings, (2) Check Valves, (2) Check Valve Springs, (1) WedgeChek™ Punch Tip, (13, 14, 15, 16, 33, 71) (1) Bottle Drawdown Air Valve
	PASWK002	Commonly Used Parts Kit - Includes: Adapter Lock Nut, Dose Adjustment Ring, Bottle Clamp, Storage Cap, (18, 25, 50, 51)
	PASWK004	Bottle Feed Adapter Kit - Includes: Bottle Drawdown Attachment, Bottle Seal, Bottle Clamp, Storage Cap, (48, 49, 50, 51)

* Included in PASWK001 † Not available as a separate replacement part

Wedge™ Direct-Inject™, Wedge™ Tip and WedgeChek™ are trademarks of ArborSystems™.

Wedge™ Tip is protected by U.S. Patent #5,239,773. WedgeChek™ is protected by U.S. Patent #5,797,215.

www.ArborSystems.com

SW100Parts/BR_05-102